

4th Generation Industrial Full Flat IP65 Monitor



- 10.1" to 21.5" Screen, 16:9 or 16:10 Aspect Ratio
- Black or Silver Color Optional
- Ultra Flat Narrow Bezel Compact Design
- OEM, ODM, Customized Available

Feature

True Flat IP65 Front Panel With Seamless Design

Aluminum Alloy Material

10mm Thickness Front Panel

Industrial Appearance, Silent Heat Dissipation

High & Low Temp

Anti-Interference

Rugged Design

Capacitive/Resistive

Effective Heat-Dissipation Back Cover Design

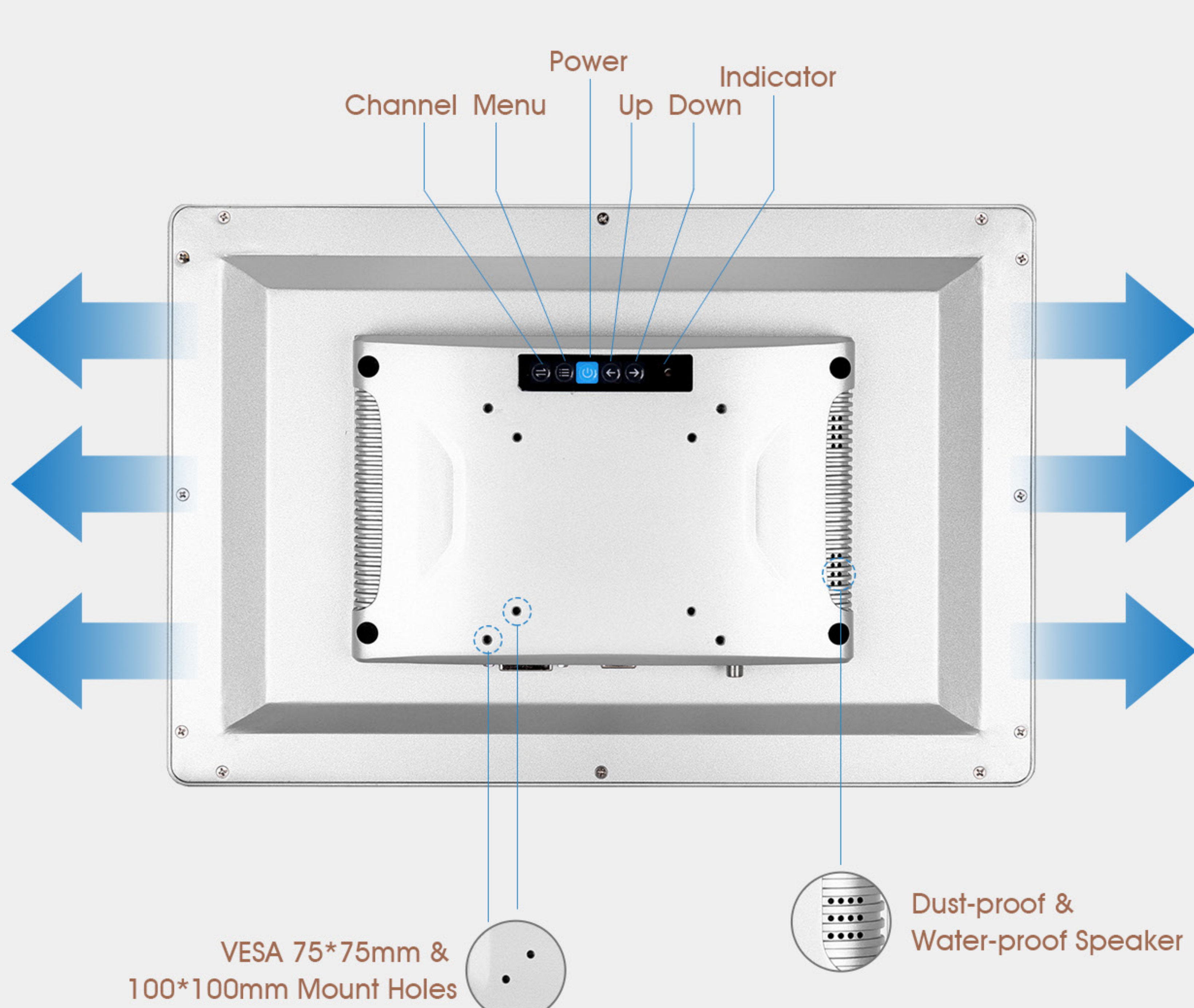

Interfaces 10.1" ~ 15.6"

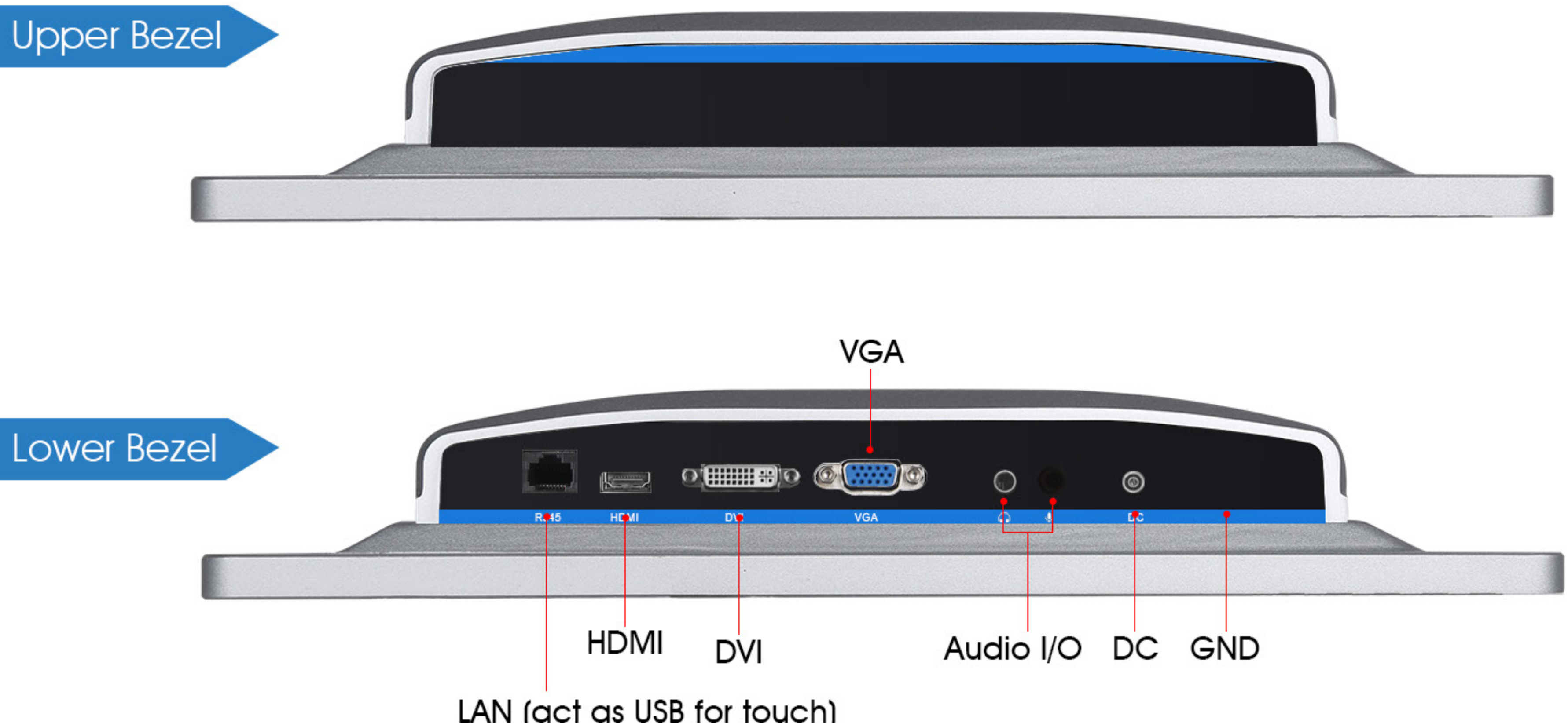

Interfaces 17.3" ~ 21.5"

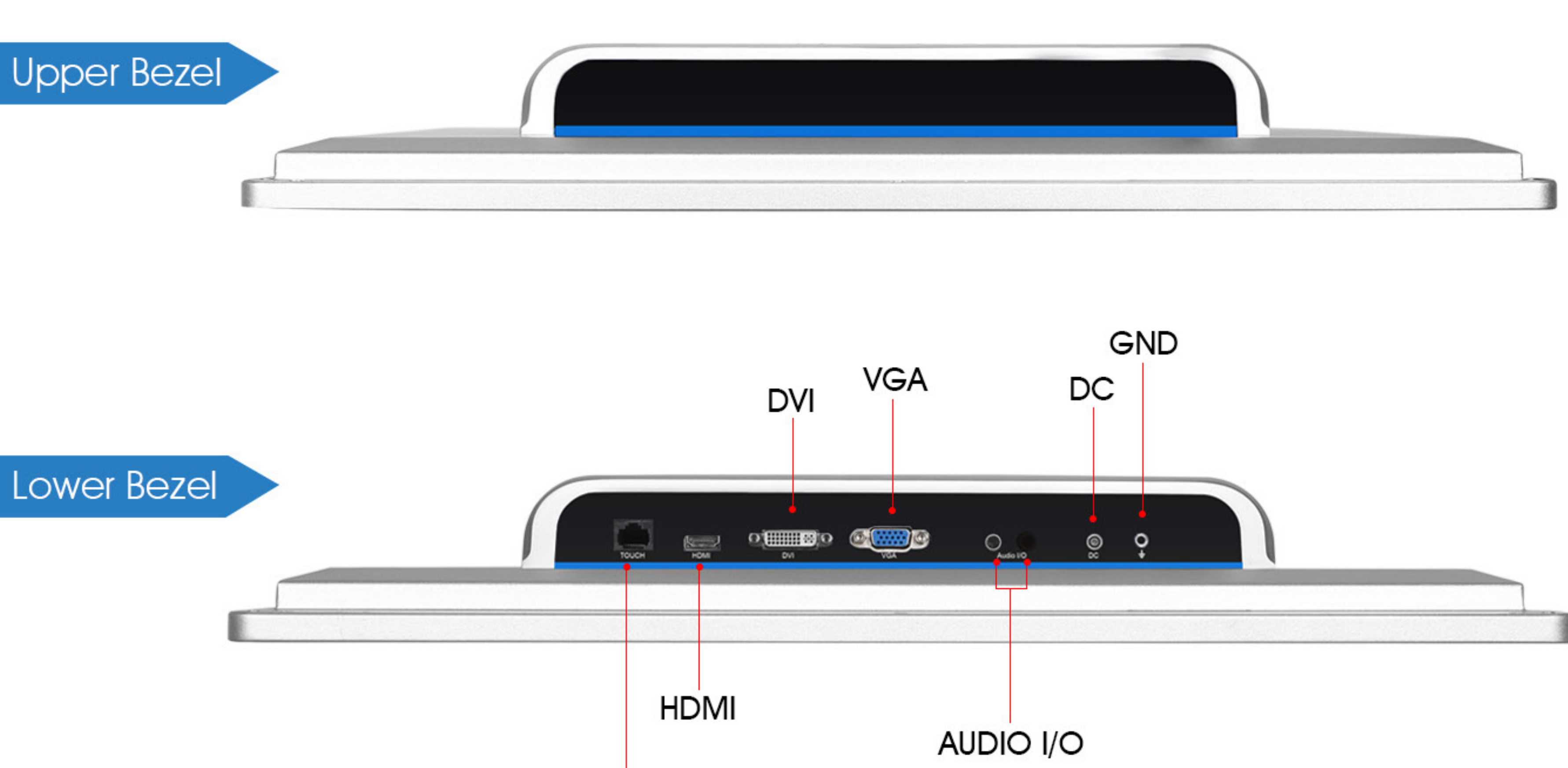

Installation

Wall Hung with Bracket (Optional)

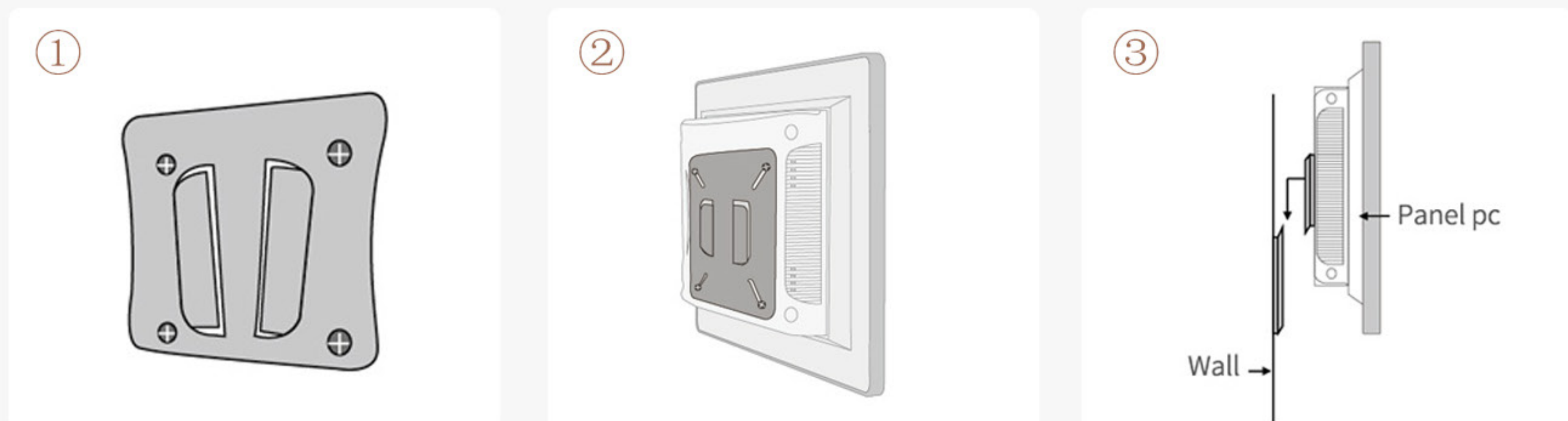

Desktop with Bracket (Optional)

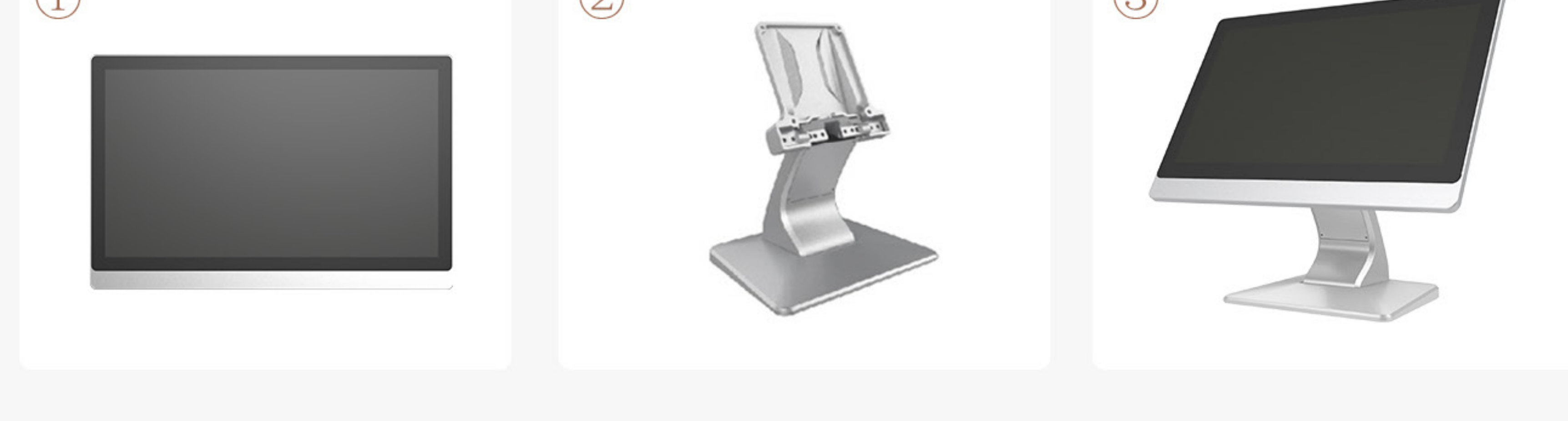

Specification

Items/Inches		10.1"	11.6"	15.6"	17.3"	19"	21.5"	
Screen Parameter	Aspect Ratio	16:10	16:9	16:9	16:9	16:10	16:9	
	Resolution	1280x800	1920x1080	1920x1080	1920x1080	1440x900	1920x1080	
	Contrast	600:1	800:1	800:1	600:1	1000:1	1000:1	
	Response Time	30ms	25ms	30ms	30ms	30ms	30ms	
	Viewing Angle	10.1" & 11.6" & 15.6": 85/85/85(L/R/U/D); 17.3": 80/80/80(L/R/U/D); 19"W: 85/85/80/80(L/R/U/D); 21.5": 89/89/89(L/R/U/D)						
	Chromaticity	16.7M						
	Brightness	300cd/m ²						
Touch Screen	Type	No Touch/Resistive Touch/Capacitive Touch (Resistive touch is not available for 11.6 inch)						
	Hardness of Surface	7H						
	Backlight Type	LED Backlight Screen						
	Service Life of Backlight	Capacitive ≥50000h; Resistive ≥35000h						
Product Reliability	Working Temp	-10°C~60°C						
	Storage Temp	-20°C~70°C						
	Humidity	95% Non-Condensing						
	Average Life	7*24H						
	Power Consumption (Running)	9W	9W	10W	23W	21W	14W	
Interfaces	Signal Interface	VGA, HDMI, DVI						
	Touch Interface	RJ45 act as USB for touch						
Hardware Configuration	Chip	RTD2183						
	Language Menu	English, Chinese, French, German, Spanish, Russian, Italian, Korean						
	Video Input	PC-RGB Format: Up to 1920*1080@60Hz; PC-RGB Color: 16bit, 24bit, 32bit; I2C: DDC, EDID						
	Button Functions	Channel, Menu, Power, Up, Down, Indicator						
	Audio Output	2*3W@8Ω						
	Power Input	AC 100~240V 50/60Hz						
	Power Output	DC12~24V/4A						
Other Parameter	Color	Silver/Black						
	Protection Level	Front panel IP65 dust and water proof						
	Material	Aluminum Alloy						
	Speaker	Built-in Speaker Optional						
	Packing List	Power Adapter, VGA Cable, RJ45 Touch Cable (for touch model)						